

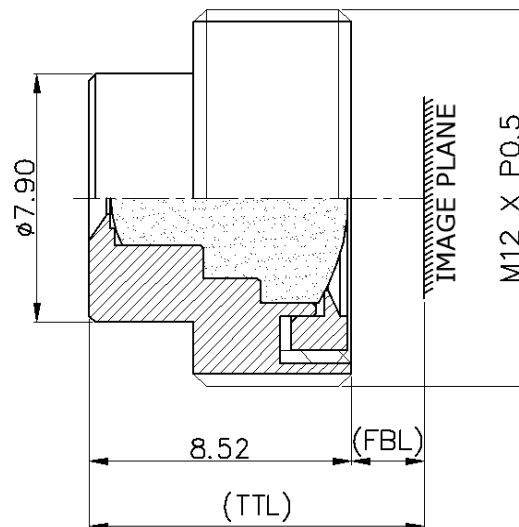

80570AM

Application		Machine Vision		
Focal Length		7.8mm		
F No.		7.0		
Iris		Fixed		
MAX Image Circle Diameter		Φ 6.4		
Sensing Area		SONY IMX296		
Object Distance		1000.0mm	114.5mm	85.0mm
Flange Back Length		2.40mm	2.89mm	3.08mm
Back Focal Length		2.5mm	3.0mm	3.2mm
Total Track Length		10.92mm	11.41mm	11.6mm
Optical Distortion		-2.6%	-3.3%	-3.6%
Angle of View	Diagonal	44.44%	43.52	43.14
	Horizontal	36.05%	35.14	34.784
	Vertical	26.96%	26.2	25.92
Chief Ray Angle(1.0F)		7.9°	8.0°	8.0°
Relative Illumination(1.0F)		81.7%	86.0%	87.5%
Resolution [@75lp/mm]	On-Axis	59.8%	58.6%	57.2%
	0.7 Field	(S)56.7% / (T)51.1%	(S)55.9% / (T)51.9%	(S)55.5% / (T)51.9%
M.O.D		670mm - ∞	109mm - ∞	82mm - ∞
Wavelength		Visible		
Filter		IR Cut Filter : 650nm Cut(T:50%)		
Waterproof		-		



Object Distance	1000.0mm	114.5mm	85.0mm
FBL	2.40mm	2.89mm	3.08mm
TTL	10.92mm	11.41mm	11.6mm

Tolerance: ± 0.4 mm